

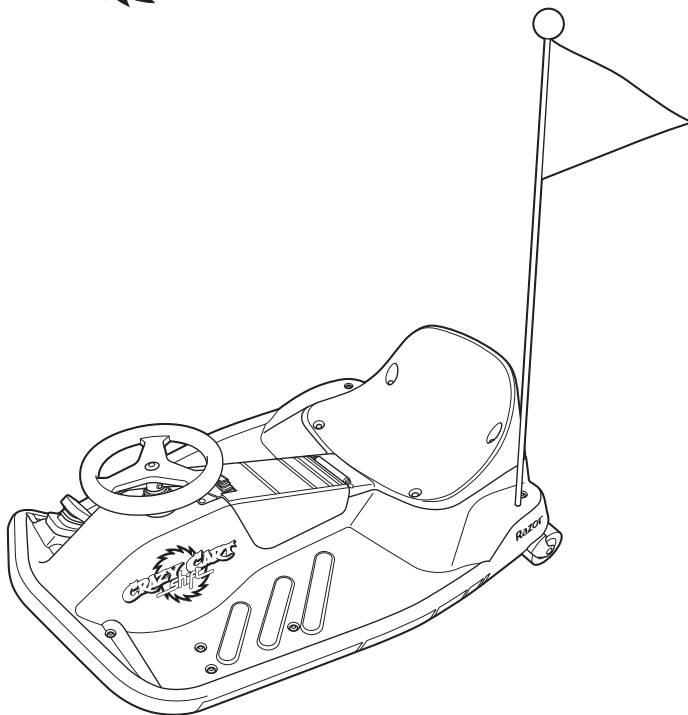

EN Read and understand this guide before using product.  
ZH 使用产品前请阅读并理解本指南。



**Crazy Cart™ Shift™**



1-15



16-21



22-29

[www.razor.com](http://www.razor.com)



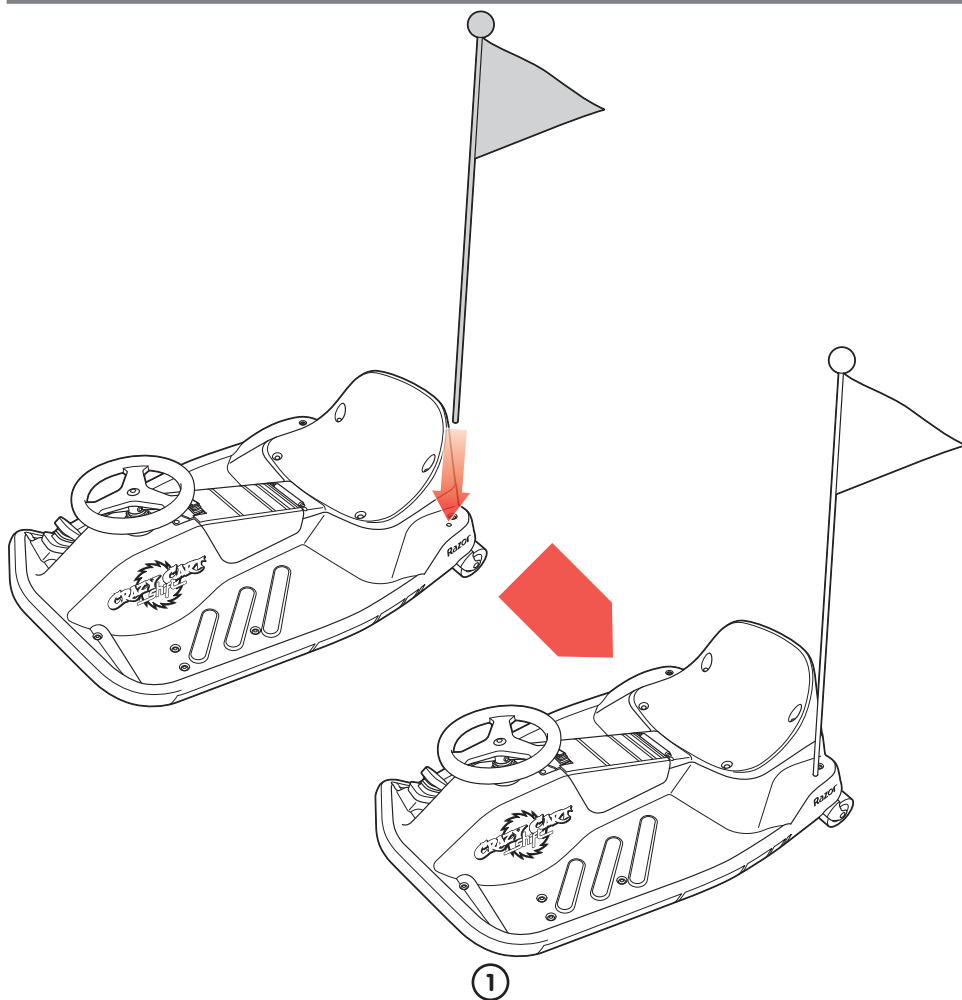
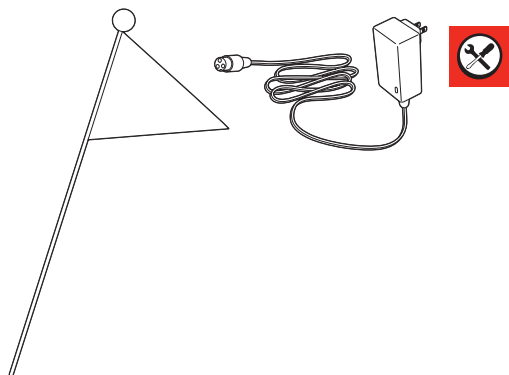
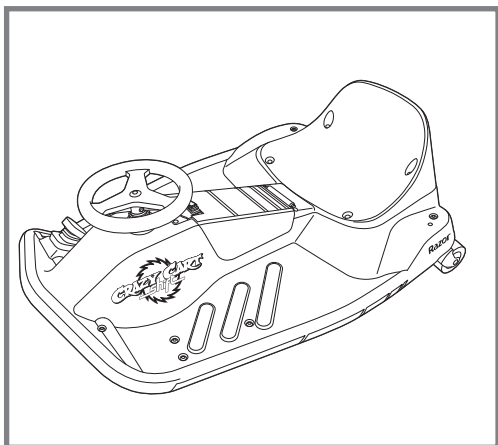

1

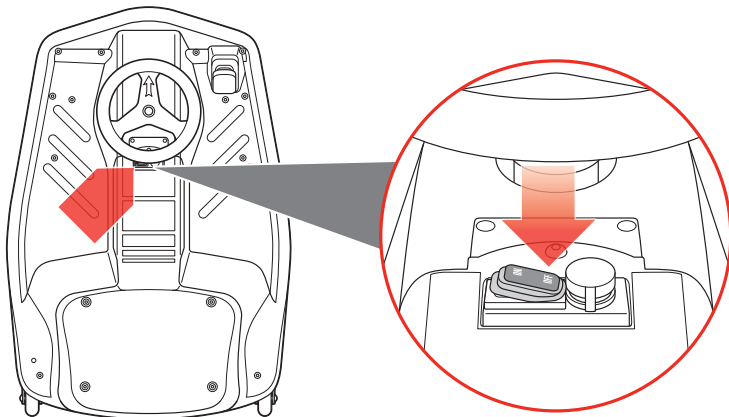

2

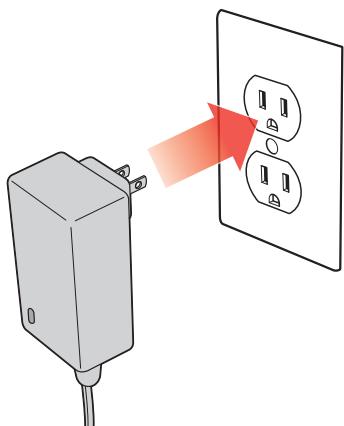

3

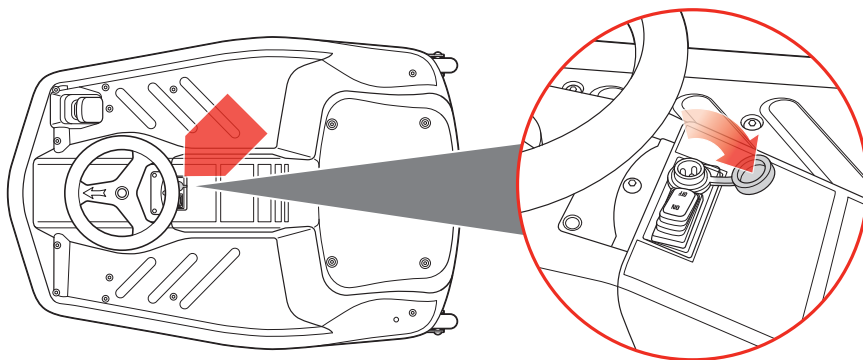

4

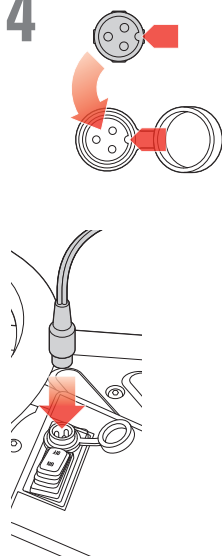

5

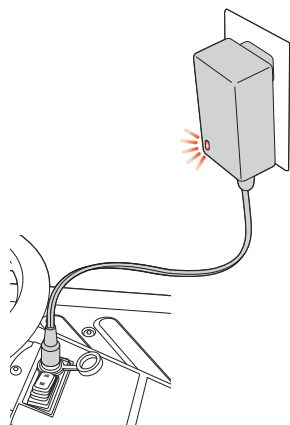

6

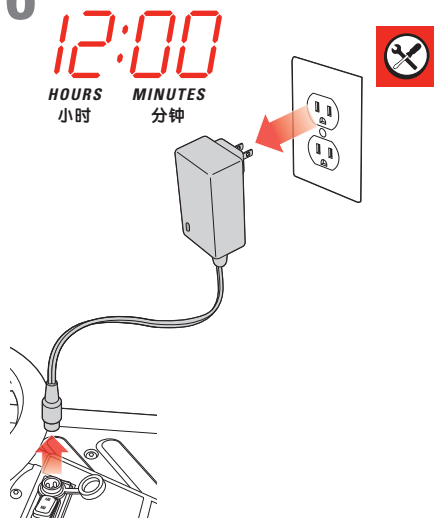

7

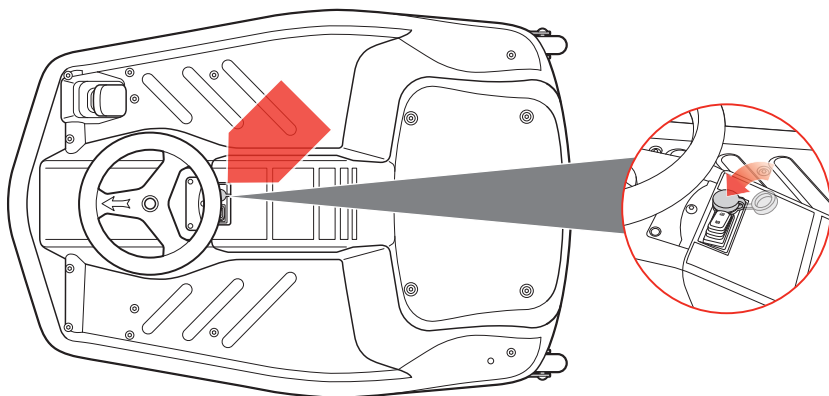



EN Repair and Maintenance

ZH 维修和维护

13mm

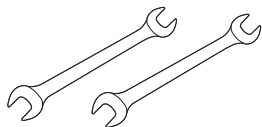

2.5mm



1

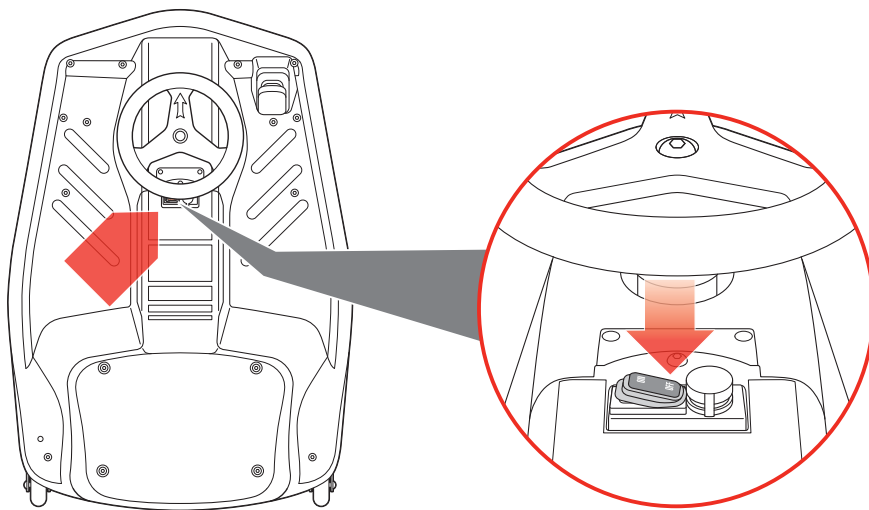

2

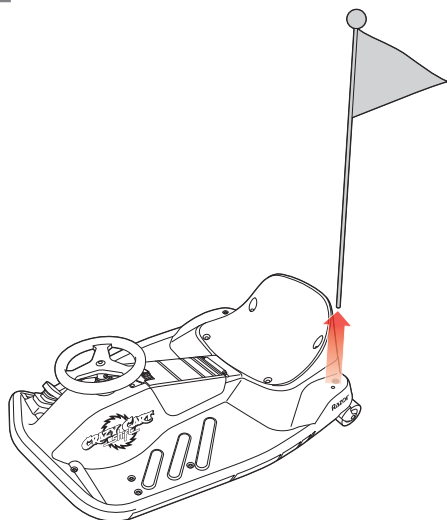

3

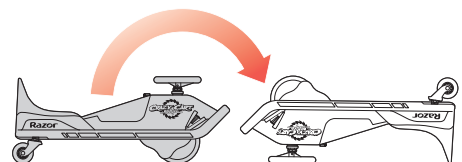

4

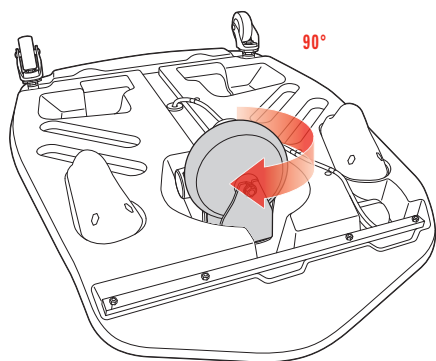

5

13mm

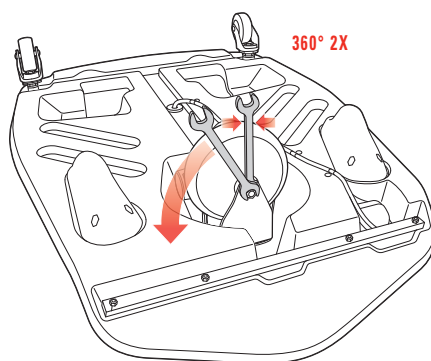

6

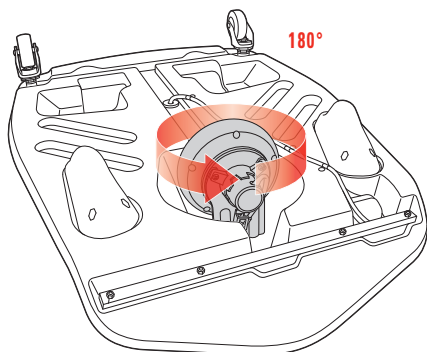

7

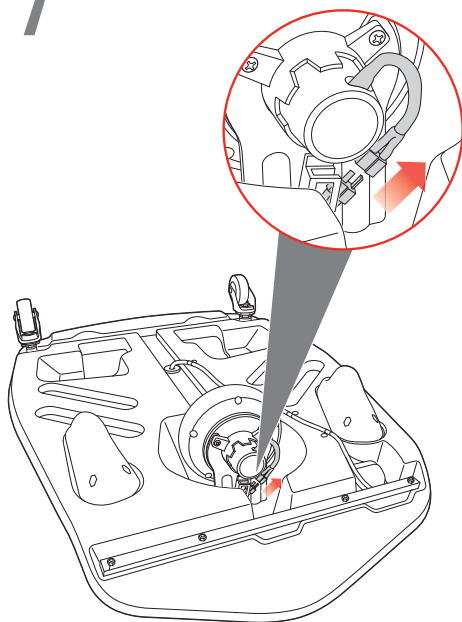

8

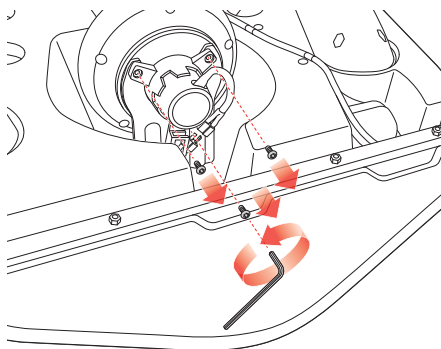

9

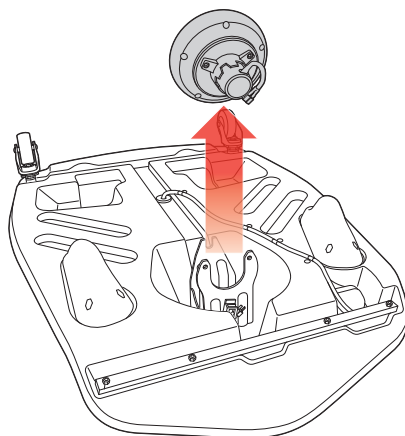



# 10

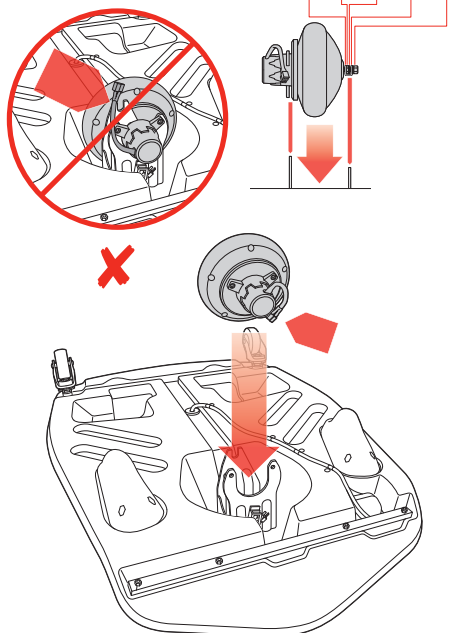

# 11

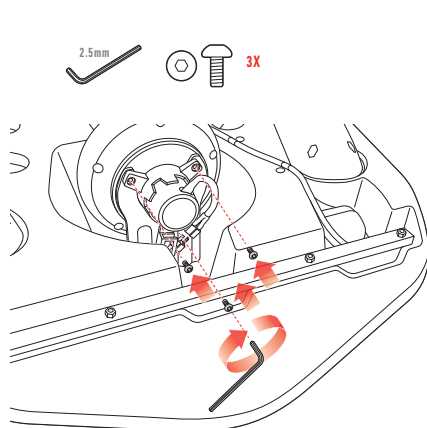

# 12

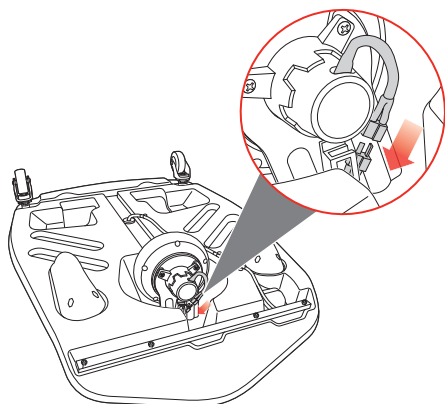

# 13

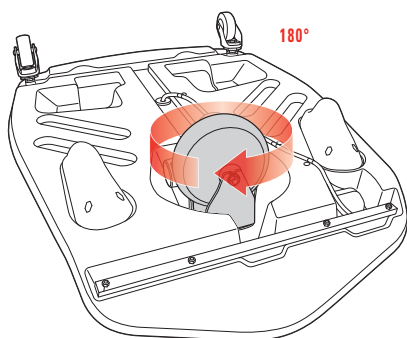

# 14

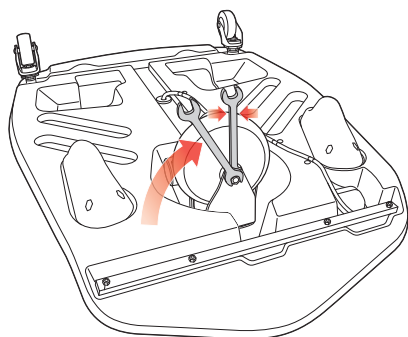

# 15

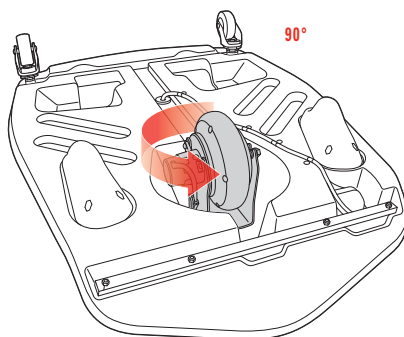

# 16

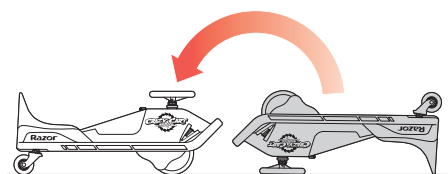

# 17

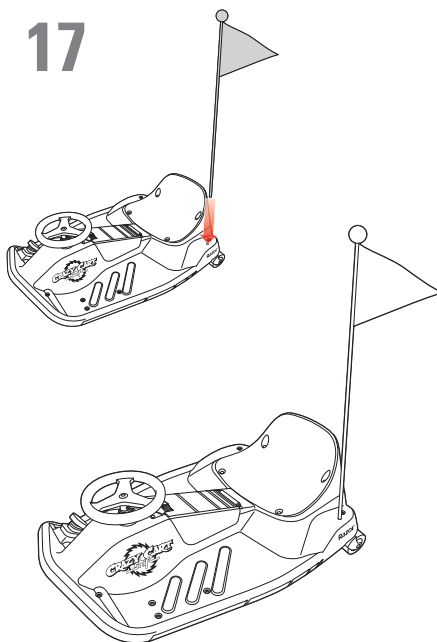

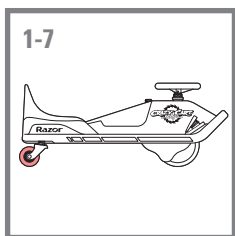

1

5 mm

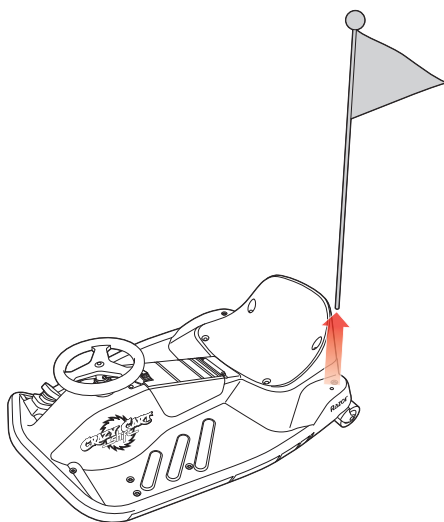

2

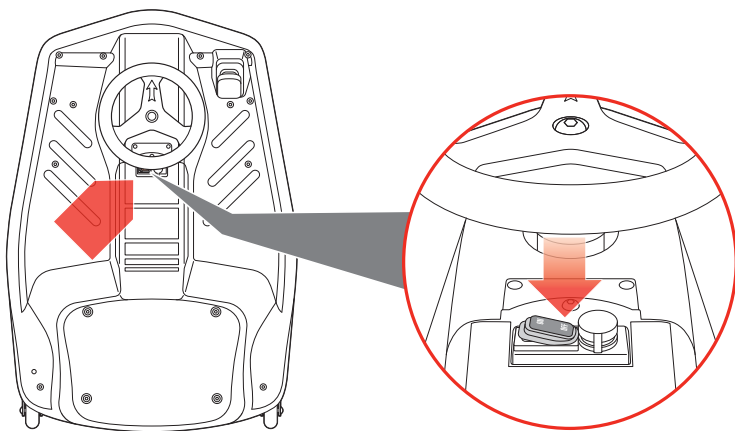

3

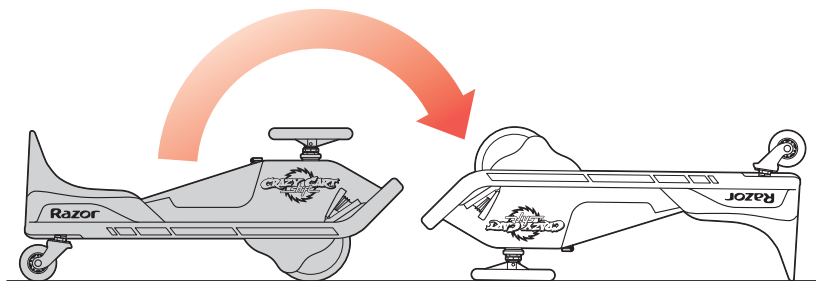

4 4.1

4.2

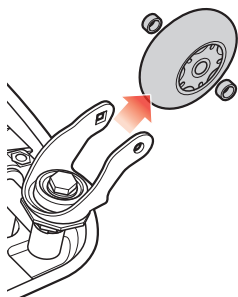
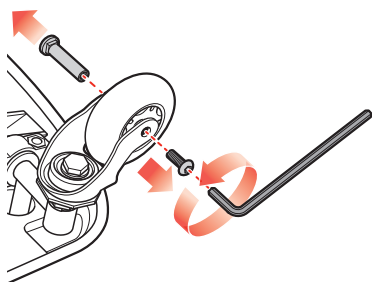

5 5.1

5.2

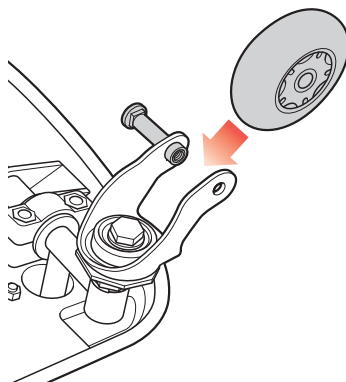
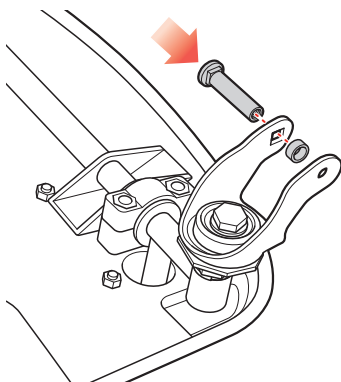

5.3

5.4

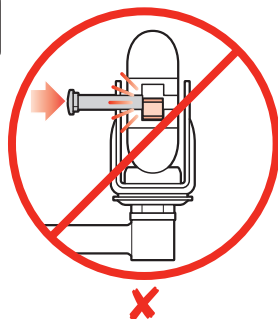
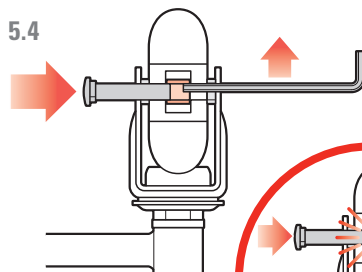
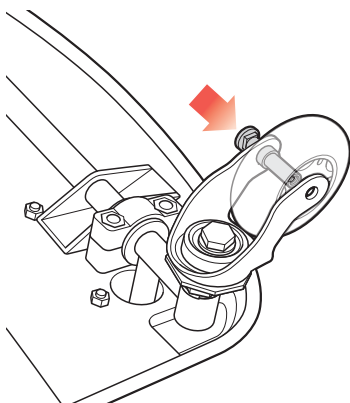

5.5

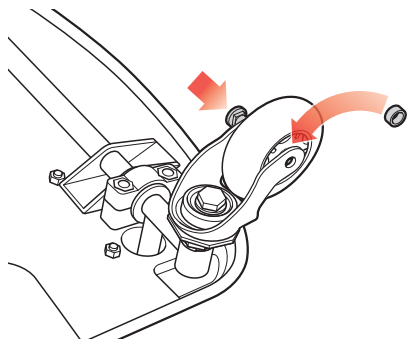

5.6

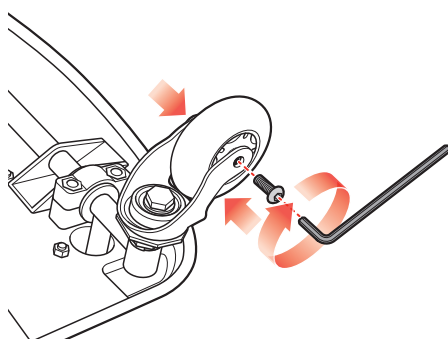

6

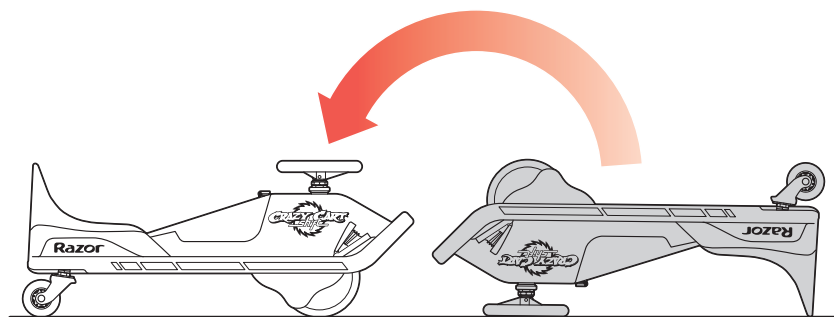

7

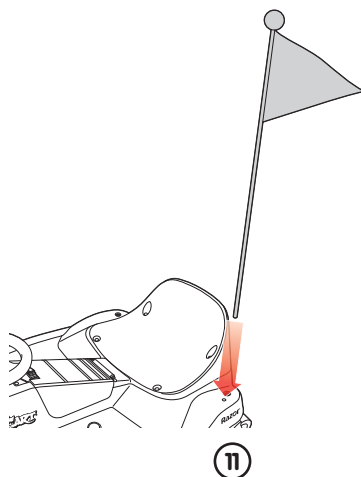

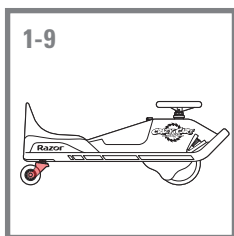

1

22 mm

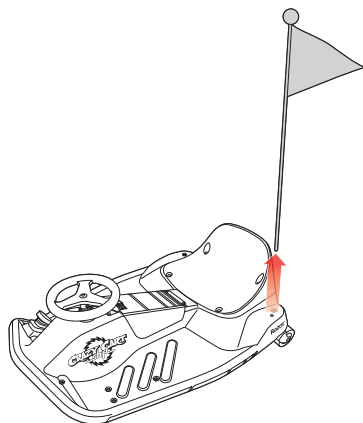
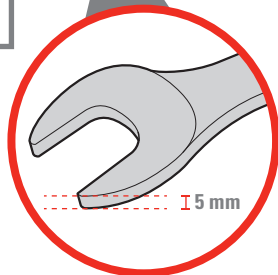
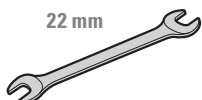

2

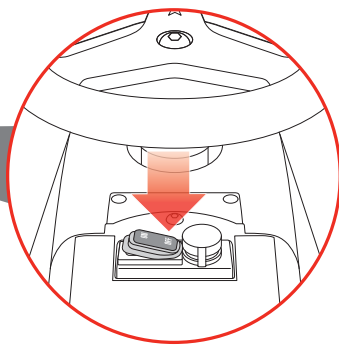
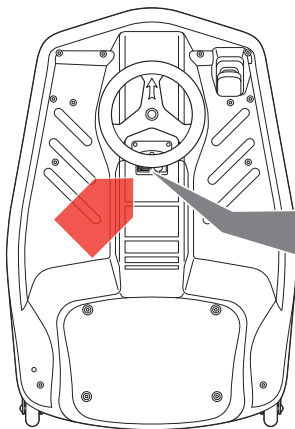

3

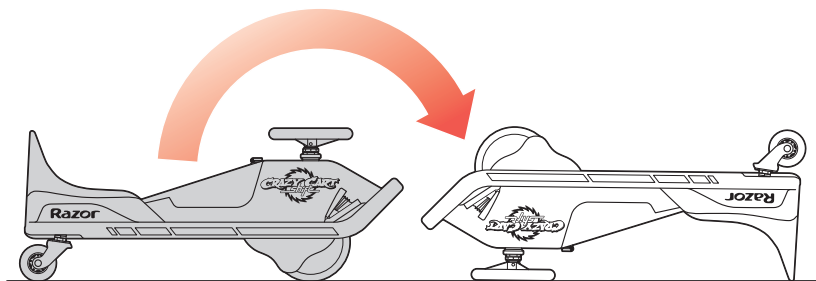

4



#4.1-4.2

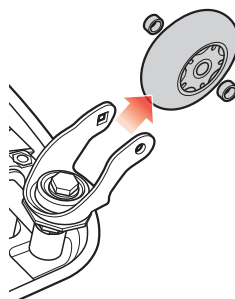
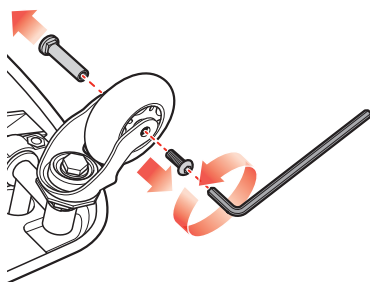

5 5.1

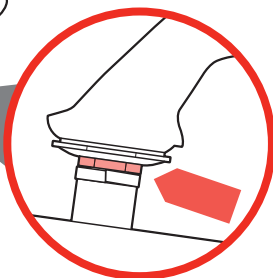
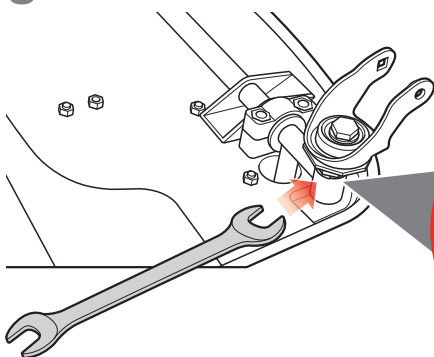

5.2

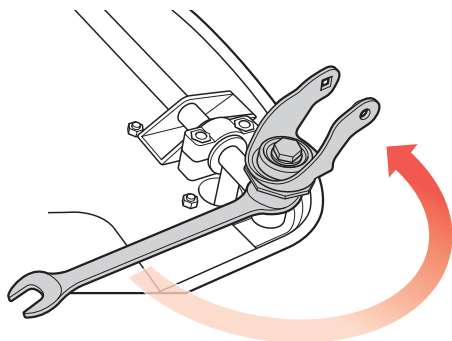

5.3

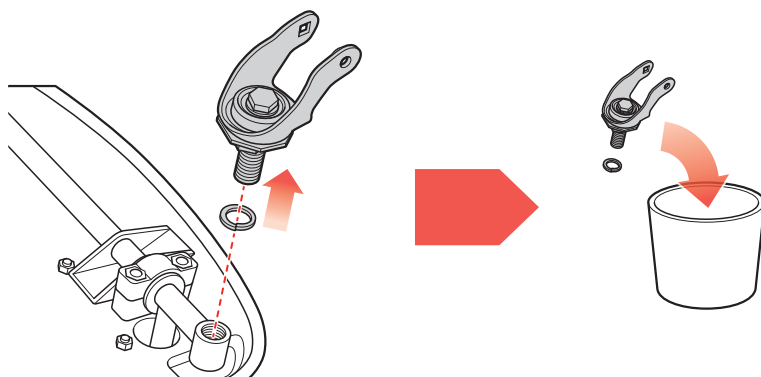

6 6.1

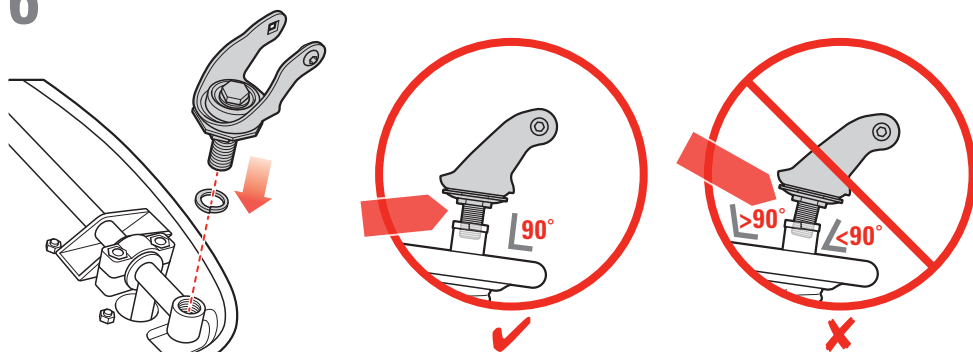

6.2

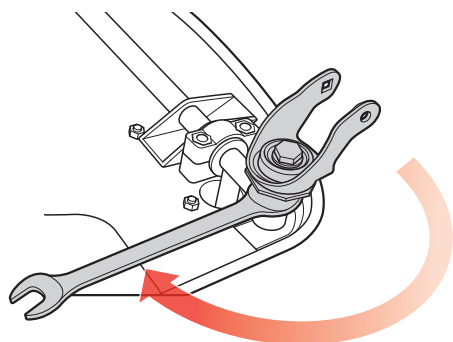



7

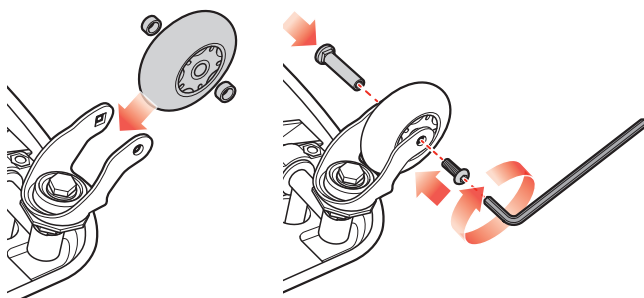

8

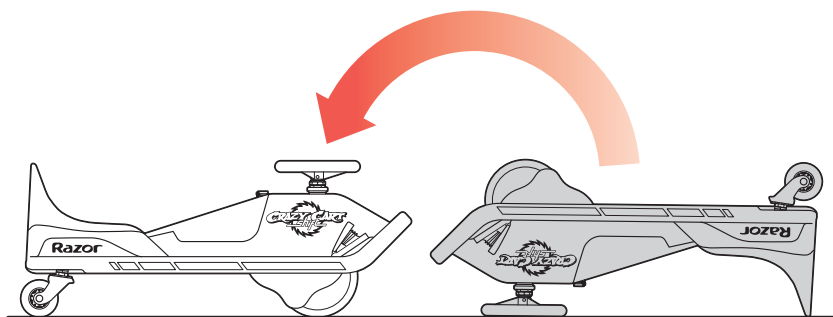

9

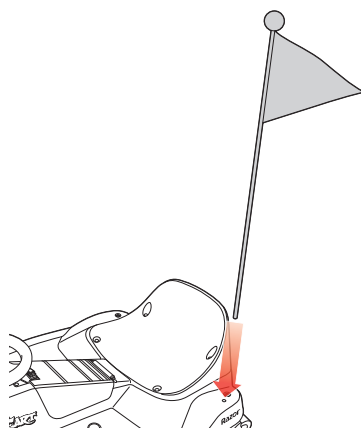

15



**⚠ WARNING:** The Crazy Cart Shift is not the same as an “ordinary” go-kart and therefore **may require greater skill to ride than an ordinary go-kart.** The Crazy Cart Shift is designed to allow movement forward, backward, laterally, in drifting arcs and even to pivot around in circles-- and instead of a “conventional” brake, it uses these new features to also allow very quick stopping and braking. It is extremely important to start out slowly, and take the time to get familiar and comfortable with the Crazy Cart Shift’s unique directional control and braking abilities, before attempting quick turns or other fast moving actions, or otherwise trying to make full use of the Crazy Cart Shift’s capabilities. **Using this product requires flat open space, free of traffic or other obstacles.**

**⚠ WARNING:** Riding any electric product can be a hazardous activity. Certain conditions may cause the equipment to fail without fault of the manufacturer. Like other electric ride-on products, the Crazy Cart Shift can and is intended to move, and it is therefore possible to lose control, fall off and/or get into dangerous situations that no amount of care, instruction or expertise can eliminate. If such things occur you can be seriously injured or die, even when using safety equipment and other precautions. **USE WITH EXTREME CAUTION.**

**⚠ WARNING: PARENTAL AND ADULT RESPONSIBILITY AND SUPERVISION NECESSARY:** This manual contains important safety information. It is your responsibility to review this information and make sure that all riders understand all warnings, cautions, instructions and safety topics, and assure that young riders are able to safely and responsibly use this product. Razor recommends that you periodically review and reinforce the information in this manual with younger riders, and that you inspect and maintain your children’s product to ensure their safety.

**⚠ WARNING: NOT FOR CHILDREN UNDER AGE 8 OR HEAVIER THAN 120 LB (54 KG).** Because products, like the Crazy Cart Shift, can and do present potential hazards plainly associated with their use, it is well recognized THE NEED FOR EXERCISE OF PARENTAL RESPONSIBILITY IN SELECTING RIDING PRODUCTS APPROPRIATE TO THE AGE OF A CHILD, OR PARENTAL SUPERVISION IN SITUATIONS IN WHICH CHILDREN OF VARIOUS AGES MAY HAVE ACCESS TO THE SAME RIDING PRODUCTS, IS IMPORTANT. Not every product is appropriate for every age or size of child, and different age recommendations are found within this category of product which are intended to reflect the nature of the hazards and the expected mental or physical ability, or both, of a rider to cope with the hazards.

Razor recommends that children under the age of 8 not be permitted to use this product. This recommendation is based not just on age or weight or height – it reflects consideration of expected maturity and skills as well as physical size. The recommended rider age of 8 years or older is only an estimate and can be affected by the rider’s size, weight or skills – not every child 8 years old will be suited to the product. Certainly, any rider unable to fit comfortably on the Crazy Cart Shift should not attempt to ride it, but a **parent’s decision to allow his or her child to ride this product should be based on the child’s maturity, skill, and ability to follow rules. Razor emphasizes that adults are strongly advised not to disregard Razor’s recommendations or permit younger children to ride the Crazy Cart Shift.**

DO NOT EXCEED THE WEIGHT LIMIT OF 120 lb (54 kg). Rider weight alone also does not necessarily mean a person’s size is appropriate to fit or maintain control of the Crazy Cart Shift. Keep this product away from small children and remember that this product is intended for use only by persons who are, at a minimum, completely comfortable and competent while operating the product.

Persons with any mental or physical conditions that may make them susceptible to injury, impair their physical dexterity or mental capabilities to recognize, understand, and follow safety instructions, and to be able to understand the hazards inherent in a product’s use, should not use or be permitted to use products inappropriate for their abilities. Persons with heart conditions, head, back or neck ailments (or prior surgeries to these areas of the body), or pregnant women, should be cautioned not to operate this product.

**NOTICE:** This manual contains many warnings and cautions concerning the consequences of failing to maintain, inspect or properly use your electric ride-on product. Because any incident can result in serious injury or even death, we do not repeat the warning of possible serious injury or death each time such a possibility is mentioned.

#### CHECK AND MAINTAIN

Before use, check to confirm that any and all covers and guards are in place and in serviceable condition. Check that the parts are functioning properly, and that the main driving wheel is not worn out and needs to be replaced. The Crazy Cart Shift should be maintained and repaired in accordance with the manufacturer’s specifications, using only the manufacturer’s authorized replacement parts, and should not be modified from the manufacturer’s original design and configuration. Replace worn or broken parts immediately.

**⚠ WARNING: SAFE OPERATION REQUIRES CAREFUL ATTENTION. This product does not have a traditional brake – stopping is done using the accelerator pedal and steering. Read “How to Operate” section of this manual and practice to develop skills in using the Crazy Cart Shift.**

- **Always check and obey any local laws or regulations which may affect the locations where the Crazy Cart Shift may be used.** The Crazy Cart Shift is meant to be used on private property and on closed courses, and not on public streets or sidewalks. Do not ride your electric product in any areas where pedestrian or vehicle traffic is present.
- Do not turn the power switch in the Crazy Cart Shift to **ON** or depress/activate the accelerator pedal unless you are seated and in a safe, outdoor environment suitable for riding. Always turn the power switch to **OFF** before exiting the Crazy Cart Shift.
- Keep your fingers and other body parts away from the steering system, wheels and all other moving components.
- Maintain a hold on the steering wheel at all times.
- Ride defensively. Watch out for potential obstacles that could catch your wheel(s) or force you to swerve suddenly or lose control. Be careful to avoid pedestrians, skaters, skateboards, scooters, bikes, children or animals who may enter your path, and respect the rights and property of others.
- This product was manufactured for performance and durability, but is not impervious to damage. Bumping into obstacles or other aggressive riding can overstress and damage any product, including the Crazy Cart Shift, and the rider assumes all risks associated with high-stress activity. This product is not a “bumper car.”
- Never carry passengers or allow more than one person at a time to ride the electric product.
- Never use headphones or a cell phone when riding. Never hitch a ride with another product.
- Do not ride the Crazy Cart Shift in wet or icy weather and never immerse this electric product in water, as the electrical and drive components could get damaged by water or possibly create other unsafe conditions.
- Wet, slick, bumpy, uneven or rough surfaces may increase risks. Do not ride this electric product in mud, ice, puddles or water. Avoid excessive speeds that can be associated with downhill rides. Never risk damaging surfaces, such as carpet or flooring, by using an electric product indoors.
- Never use near steps or swimming pools.
- Do not ride at night or when visibility is limited.
- You may see people on TV or videos performing stunts and trick maneuvers on the Crazy Cart Shift. These are people who have been practicing a long time and who accept the risks of trick riding. Do not assume that you can attempt to do the same tricks without great risk.

- Be careful and know your limitations. Risk of injury increases as the degree of riding difficulty increases. The rider assumes all risk associated with aggressive riding activities.



#### **Proper Riding Attire**

Always wear proper protective equipment, such as an approved safety helmet (with chin strap securely buckled). A helmet may be legally required by local law or regulation in your area. Elbow pads and kneepads, a long-sleeved shirt, long pants and gloves are recommended. Always wear athletic shoes (lace-up shoes with rubber soles), never ride barefooted or in sandals, and keep shoelaces tied and out of the way of the wheels, motor, and drive system.

#### **Using the Charger**

- The charger supplied with the Crazy Cart Shift should be regularly examined for damage to the cord, plug, enclosure and other parts. In the event of such damage, the Crazy Cart Shift must not be charged until the charger has been repaired or replaced.
- Use only a charger recommended by Razor.
- Use caution when charging.
- The charger is not a toy. Charger should only be operated by an adult.
- Do not operate charger near flammable materials or an open flame.
- Unplug charger and disconnect from Crazy Cart Shift when not in use.
- Do not exceed charging time.
- Always disconnect Crazy Cart Shift from charger prior to wiping it down or cleaning with a damp cloth.

**FAILURE TO USE COMMON SENSE AND HEED THE WARNINGS INCREASES RISK OF SERIOUS INJURY. USE WITH APPROPRIATE CAUTION AND SERIOUS ATTENTION TO SAFE OPERATION.**



**CONTAINS SEALED NON-SPILLABLE LEAD  
ACID BATTERIES.  
BATTERIES MUST BE RECYCLED.**

**Bolt Tightening Torsion Value Reference Chart**

Please refer to chart below to ensure the bolt you have tightened corresponds to below torsion value according to its relevant diameter.

Bolt Diameter	Torsion Value Recommended
Normal Bolt	Torsion Value (N-M)
5mm	5
6mm	10
8mm	21
10mm	34
12mm	53

**警告：** Crazy Cart Shift 不同于“普通型”卡丁车，因此骑乘时可能需要比普通卡丁车更高的技巧。Crazy Cart Shift 卡丁车可以完成向前、向后、侧向和弧线漂移运动，甚至可以完成定圆漂移。没有“传统的”刹车，Crazy Cart Shift 卡丁车使用这些新功能实现快速停止和刹车。开始骑乘时，请务必采用低速，花些时间熟悉并适应 Crazy Cart Shift 卡丁车独特的方向控制和刹车功能，然后循序渐进地尝试快速旋转或其他高速运动，逐步掌握 Crazy Cart Shift 的各种功能。请在平坦空旷、没有车辆或其他障碍物的场地使用本产品。



**警告：** 骑乘任何电动产品都可能是危险的活动。某些条件可能导致设备出现故障，并非制造商的过错。和其他电动骑乘产品一样，Crazy Cart Shift 可运动，这也是设计目的；因此，无论采取多么周全的防护措施、指导或有多么娴熟的技能，都可能会不可避免地发生失控、跌落和/或遭遇危险的情况。如果发生上述情况，即使使用安全设施和其他预防措施，都可能造成严重的伤亡。请谨慎使用本产品。

**警告：** 父母和成人应负责并监督：本手册包含重要安全信息。您有责任回顾这些资料，确保所有骑乘者了解全部的警告、注意事项、使用说明和安全议题，保证年轻的骑乘者能够安全负责地使用该产品。Razor 建议您定期给年纪较小的骑乘者回顾手册内容巩固理解，并且检查维护您子女使用的产品以确保使用安全。

**警告：** 8 岁以下或体重超过 54 公斤的儿童不宜使用。因为像 Crazy Cart Shift 这样的产品就其用途而言会有也确实存在潜在危险，所以公认的是，在给予孩子挑选适合其年龄段的骑乘产品时父母应履行责任，或不同年龄段的儿童可能接触同类产品的情况下父母应做好监管，这都至关重要。并非每种产品适合于每个年龄段或体型的儿童——不同年龄的建议产品请见该产品类别，该类别反映了危险的性质，以及儿童应对危险的预期智力和/或身体能力。

Razor 建议 8 岁以下儿童不得使用本产品。此项建议不仅基于年龄或体重或身高——还纳入了对使用者预期成熟度、技巧和体型的考虑。儿童建议使用年龄为 8 岁或以上仅为估值，可能会受到骑乘者的体型、体重或技巧的影响，并非每个 8 岁的儿童都适合使用本产品。当然，任何不能舒适地使用 Crazy Cart Shift 的骑乘者都不应尝试骑乘，父母应该根据子女的成熟度、技巧和遵守规则的能力来决定是否允许其骑乘本产品。Razor 强调，成人绝不可忽视 Razor 的建议或让年纪较小的儿童骑乘 Crazy Cart Shift。

骑乘者体重必须在 54 公斤以下。即使骑乘者的体重符合条件，也不意味着其体型适合或能掌控 Crazy Cart Shift。将本产品放在年幼儿童无法接触到的地方，应记住，本产品只能由至少在操作时完全自如并胜任的人员使用。

因任何智力或身体问题而容易受伤、身体灵活性或智力可能受损而难以充分认识、理解和遵守安全指南、或难以理解本产品使用潜在危险的人士，不应使用或获准使用超出其能力范围的产品。患有心脏病、头部、背部或颈部疾病（或身体这些部位此前动过手术）的人员，或孕妇应注意不得操作本产品。

注意：本手册包含许多警告和注意事项，旨在强调不正确维护、检查或使用您的电动骑乘产品会造成的严重后果。因为任何事故都可能会造成严重的伤害甚至死亡，因此每次我们提及这样的可能性时，不再赘累可能造成严重的伤害甚至死亡的警告。

#### 检查并维护

使用前，请检查以确认任何及所有护链罩或其他罩或盖子处于正确位置，并处于可使用状态。检查确保各部件功能正常、主驱动轮未磨损且无需更换。应根据制造商的规范维护并维修 Crazy Cart Shift，请仅使用制造商授权的更换零件，且不应更改制造商的原始设计和结构。立即更换磨损或破损的部件。

**警告：** 安全操作需要高度的注意力。本产品没有使用传统的刹车，而是通过操控油门踏板和方向盘实现停车。请参阅本手册的“操作方法”部分练习使用 Crazy Cart Shift 的技巧。

- 务必检查并遵守任何本地法律或法规，这可影响到 Crazy Cart Shift 的使用位置。Crazy Cart Shift 应在私人场所和封闭道路上使用，而不应在公共街道或人行道上使用。不可在有行人或车辆来往的任何地方骑乘您的电动产品。
- 请勿将 Crazy Cart Shift 的电源开关设置为 ON（开）或踩下/激活油门踏板，除非您已坐好且在户外适合骑乘的安全环境中。从 Crazy Cart Shift 上下车之前，务必将电源开关设置为 OFF（关）。
- 让您的手指和身体的其他部位远离转向系统、车轮和其他所有运动元件。
- 必须始终掌握方向盘。
- 骑乘时注意防护。注意可能卡住车轮，或迫使您突然转向或失去控制的潜在障碍物。注意防止行人、溜冰者、滑轮车、滑板车、自行车、儿童或动物可能与您相撞，尊重他人的权利并保护他们的财产。
- 本产品性能优良，经久耐用，但并不意味着不会损坏。碰撞到障碍物或其他猛闯过来的骑乘者会强烈撞击并损坏任何产品，包括 Crazy Cart Shift，因此骑乘者应承担与这些高强度活动有关的所有风险。本产品不是“碰碰车”。
- 切勿载人或允许多人同时骑乘本产品。
- 骑乘时不得佩戴耳机或使用手机。不得挂在其他产品上骑乘。
- 不得在潮湿或结冰天气骑乘 Crazy Cart Shift，不得将本产品浸入水中，因为电气和驱动零部件可能被水损坏，或可能造成其他不安全因素。
- 潮湿、光滑、颠簸、不平坦或粗糙表面会增加风险。不得在泥泞、结冰、水坑或水中骑乘本产品。下坡时速度不要过快。请勿在室内使用电动产品，否则可能损坏沙发或地板等的表面。
- 不得在楼梯或游泳池附近使用。
- 不得在夜间或能见度受限情况下骑乘。
- 您可能在电视上或视频中看到有人在 Crazy Cart Shift 上执行一些特技和高难度动作。这些人都经过了长时间的练习并承担技巧性骑乘的风险。请不要因此认为您也可以进行相同的技巧性尝试，这存在巨大的风险。
- 请务必慎重并懂得自己的能力限制。随着骑乘难度的增加，受伤的风险也会加大。骑乘者应自行承担所有与这些高难度骑乘活动有关的风险。



#### 骑乘时正确的着装

务必佩戴适当的保护设备，如经批准的安全头盔（带有安全的下巴托）。您所在位置的本地法律或法规可能要求佩戴头盔。另外，建议穿长袖衫、长裤并佩戴手套、护肘和护膝。务必穿运动鞋（系带鞋，橡胶鞋底），不得赤脚或着便鞋骑乘，系紧鞋带，并使其远离车轮、电动机和驱动系统。

#### 使用充电器

- 应该定期检查 Crazy Cart Shift 自带的充电器以防其电线、插头、外壳和其他部件破损。遇到此类破损时，在充电器修复或替换前不可给 Crazy Cart Shift 充电。
- 仅使用 Razor 推荐的充电器。
- 充电时请务必小心。
- 该充电器非玩具。充电器应由成人操作。
- 不得在可燃材料或明火附近操作充电器。
- 不用时拔掉充电器的插头并将其从 Crazy Cart Shift 上断开。
- 充电时间不得过长。
- 用湿布拭擦或清洁之前，请先将 Crazy Cart Shift 从充电器上断开。

不遵守常识，或不注意上述警告会进一步增加重伤危险。请务必谨慎并高度注意以确保安全操作。



包含密封的防溢铅酸蓄电池。  
蓄电池必须回收。

螺栓锁紧扭矩参考

请按照下表的直径参考螺栓锁紧的扭矩值



螺栓直径	推荐扭矩
一般螺栓	扭矩 (牛/米)
5mm	5
6mm	10
8mm	21
10mm	34
12mm	53

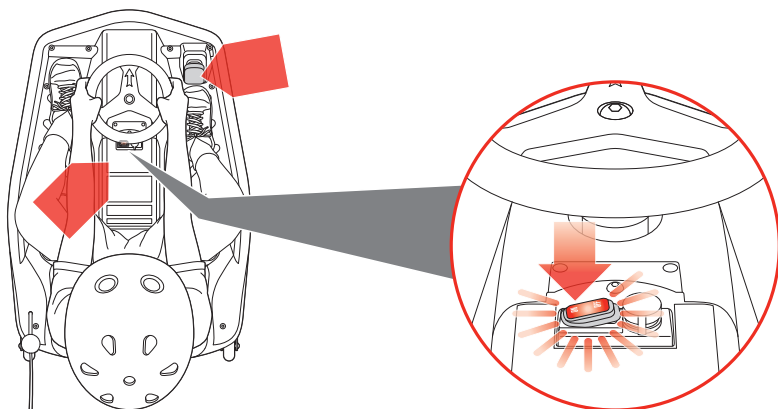

1

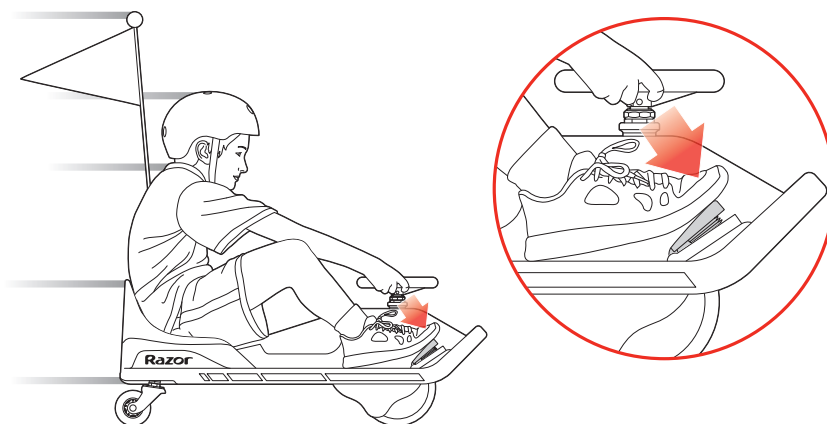





停止



1

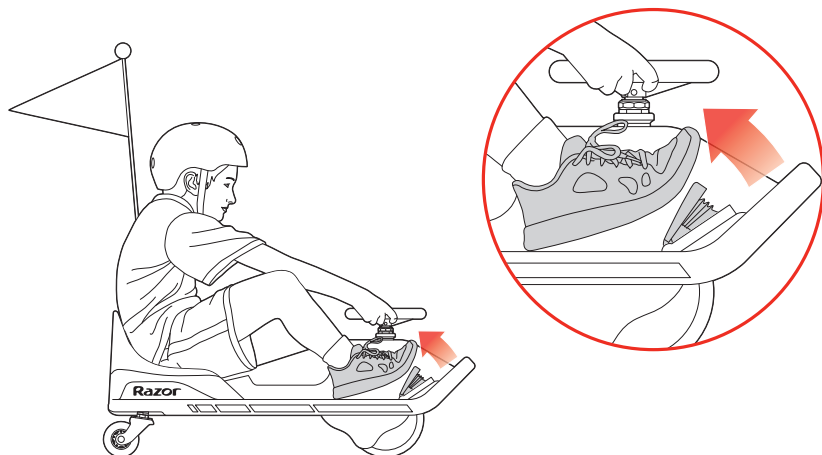

2

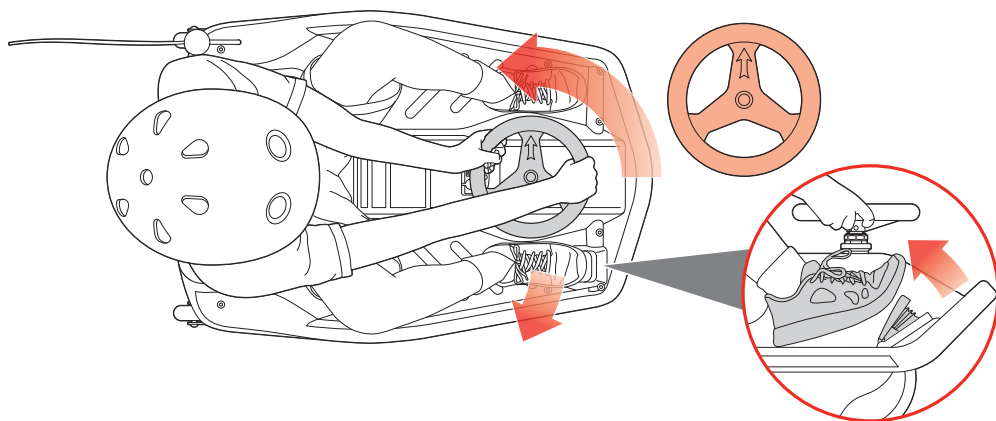

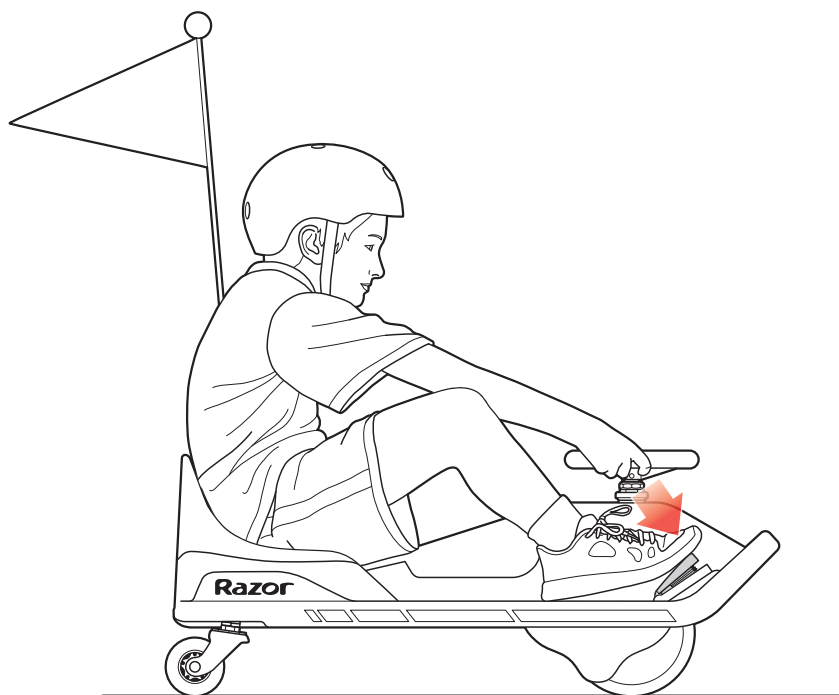

EN Direction of travel  
ZH 行进方向

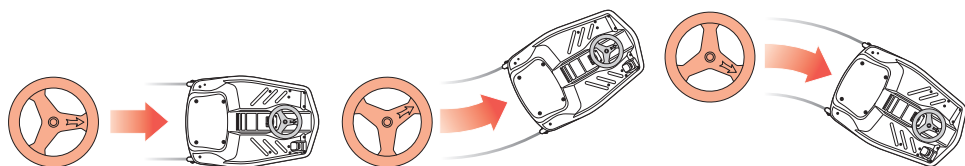

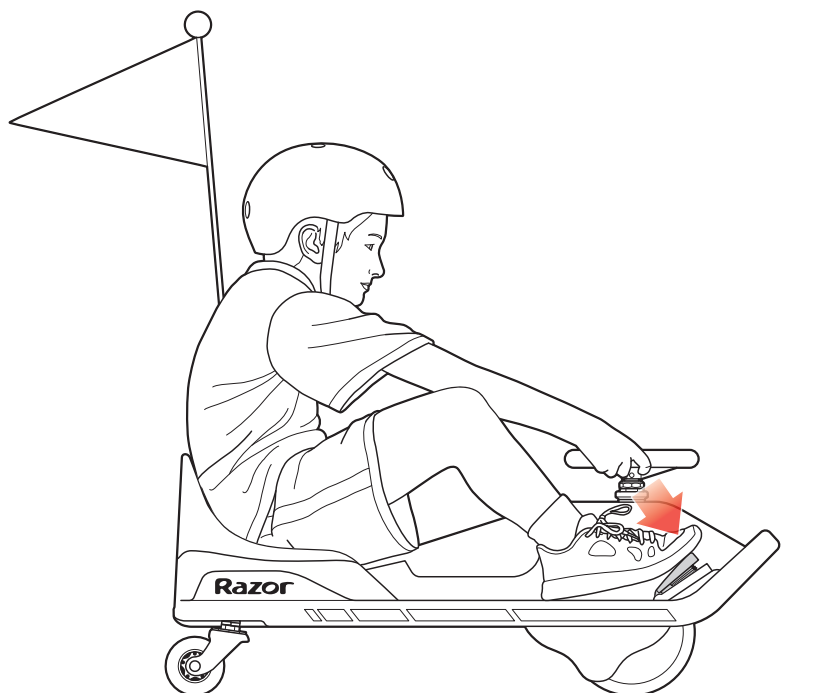

EN Direction of travel  
ZH 行进方向

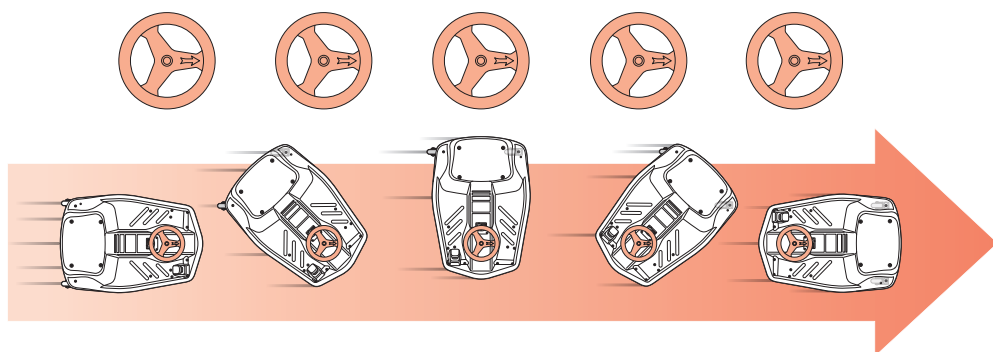



### HOW TO OPERATE THE CRAZY CART SHIFT

Before you ride this exciting new product, take the time to learn about how it moves the way it moves. Start out slowly. With practice and care, you must familiarize yourself with these riding hints and tips so that your experiences with the Crazy Cart Shift will allow you to maximize fun while keeping in control.

Never turn the ON/OFF switch to **ON** before sitting down in the driver's seat of the Crazy Cart Shift. By getting yourself situated before turning the power **ON**, you won't risk losing your balance by pushing the accelerator pedal while standing as you get into (or out of) the Crazy Cart Shift. Always turn the ON/OFF switch to **OFF** before exiting the Crazy Cart Shift.

**IMPORTANT CONTROL FEATURES: ACCELERATOR PEDAL AND STEERING WHEEL** The Crazy Cart Shift allows really creative drifting, spinning and turning that no ordinary go-kart can do. If you have ridden a Razor RipStik® or a Razor RipRider® 360, think about those caster wheels and how they allow rapid changes of direction; or how a Razor Ground Force® Drifter™ go-kart allows full speed rear-end drifting. The Crazy Cart Shift builds on these motions and adds even tighter turning possibilities through the fully rotational front drive wheel and the rear caster wheels. Practicing with the Crazy Cart Shift can lead to amazing fun, and it is important, as with all moving products, to always exercise caution when riding.

**ACCELERATOR PEDAL:** The Crazy Cart Shift has a foot pedal accelerator that controls the cart's speed. This variable speed accelerator allows you to drive the cart at a range of speeds from 0-13 KM/H (0-8 MPH), depending on how much it is depressed. This ability to dynamically speed up and slow down is a key to controlled drifting. All stopping should be preceded by releasing any pressure on the accelerator pedal.

**STEERING WHEEL:** The Crazy Cart Shift's steering wheel is different from a normal car or cart in a number of ways. The most important thing to remember about the Crazy Cart Shift's steering wheel is that the arrow on it points in the direction where the cart is going to travel, regardless of how the rest of the cart is oriented. Simply point the arrow where you want the cart to go (varying pressure on the accelerator pedal can change how the back of the Crazy Cart Shift follows, as described below).

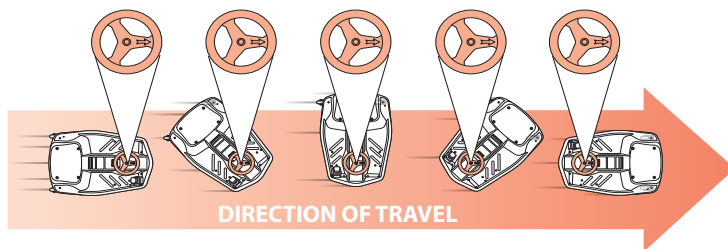

The Crazy Cart Shift's steering wheel is able to rotate more than 170° in each direction. The steering wheel has a "hard stop" when it has reached the limit of its turning – it won't keep going around all the way, but by turning fully one direction or fully the other direction, you can ride the Crazy Cart Shift backwards - and by turning at or near 90° the Crazy Cart Shift can go in a very, very tight circle (be careful to avoid losing control by turning so much as to risk becoming dizzy).

The steering configuration of the Crazy Cart Shift's integrated drive and steering mechanism is similar to what some might call "bumper car" design. It has no self-correcting camber or castering features (meaning the steering tube goes straight up and down so the wheel doesn't "align" itself on its own). Such steering might, in certain circumstances, shimmy or vibrate a little – this is normal. Usually it is the result of an uncoordinated or adverse control condition. If you feel a shimmy in the steering, a change of direction ("counter-steering") and/or speed change helps re-establish smooth control.

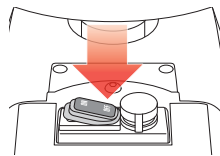

**IMPORTANT:** Always select a riding area that is level, smooth, dry, and completely free of traffic or obstacles. **DO NOT RIDE AROUND CARS!**

**RIDING TIP:** Learning when to push and when to let off of the accelerator pedal will improve your ability to do spins, drifts, and tricks smoothly. The best way to learn the Crazy Cart Shift's abilities is to try things at low speed.



**WARNING:** Excessive duration or speed in spins can lead to loss of balance, loss of control and tipping. Keeping one's limbs and head tucked in tight to the center of the Crazy Cart Shift can reduce risks of tipping over because ergonomic forces can increase risk of tipping if the body is leaning outwards and/or the spinning speed accelerates too greatly. Take your foot off the accelerator pedal if spinning becomes too fast to control, do not try to accelerate out of a spin. The Crazy Cart Shift may accelerate faster when lighter riders are on it, which is one reason the minimum recommended age is 8. Be safety conscious!



### Spinning, Drifting and Stopping the Crazy Cart Shift

The best use of the Crazy Cart Shift involves careful coordination of the steering and the accelerator. The majority of spins and drifts that can be done in the Crazy Cart Shift are accomplished by careful accelerator control and deliberate manipulation of the steering wheel. Learning where to point the arrow on the steering wheel and when to add or reduce power are the keys to smoothly controlling tricks. Smooth riding also increases the run time between charges. When first getting oriented with the Crazy Cart Shift, it is highly recommended that riders carefully apply the accelerator and take time to get familiar with the results of combining counter-steering and accelerator pedal control to manipulate the Crazy Cart Shift's spins and drifts.

There is no separate brake on the Crazy Cart Shift, but with practice it is easy to stop. Of course, removing your foot from the accelerator pedal will slow the cart down as a result of friction in the drive train. To stop the Crazy Cart Shift's forward motion immediately, take your foot off of the accelerator pedal and turn the steering wheel 90° to either side. Removing your foot from the accelerator pedal and turning the steering wheel will result in the Crazy Cart Shift spinning or drifting in a circle and slowing to a stop. By turning the steering wheel 90° and taking your foot off the accelerator pedal, the rider can immediately arrest forward motion and instead turn away. In this way, the Crazy Cart Shift can avoid collisions and evade objects in its path.

For your safety, take the time to get familiar and comfortable with various combinations of depressing the accelerator pedal and turning steering wheel to learn how to slow down and stop while maintaining control of the cart. Practice these skills for maximum rider safety.

These basic steering exercises may help to familiarize riders with their Crazy Cart Shift's capabilities:

1. First steer in a circle.
2. Make the same circles, vary how much you depress the accelerator pedal and note how the Crazy Cart Shift reacts as you increase and decrease speed while turning. You should notice that accelerating hard while turning results in the Crazy Cart Shift spinning out.
3. Still making the same circles, experiment with keeping the body of the cart from spinning out by 'counter-steering'. Counter-steering to stop the Crazy Cart Shift from spinning out is achieved by pointing the arrow on the steering wheel opposite the direction that the Crazy Cart Shift is spinning out in. So, for example, if you are turning hard toward the right, the cart may spin out in a clockwise direction. This spinning out can be countered by turning the steering wheel slightly to the left and/or reducing pressure on the accelerator pedal. Practice is the best way to master this skill.
4. Practice bringing the Crazy Cart Shift to a stop by taking your foot off the accelerator pedal and turning the steering wheel 90° to the left or right.
5. Practice staying "tucked in" during tight turns or spins.

**⚠ WARNING:** Recognize that these specialized riding features affect how the Crazy Cart Shift functions and require extra caution and attention to safe riding conditions and practices. Read and review the Safety Warnings, and be extra careful with the Crazy Cart Shift to avoid traffic, obstacles and downhill environments. This is not a "bumper car" and is not designed to engage in collisions, jumping activities or for use on surfaces other than hardened, smooth, flat and dry areas.

### 如何操作 CRAZY CART SHIFT

骑乘这款令人心动的新产品之前，请花一些时间了解如何正确操作它。开始时慢速行驶。必须小心练习让自己逐步熟悉骑乘的技巧和方法，逐步提高对 Crazy Cart Shift 的体验，以便最终能够游刃有余地操控它并获得无比的乐趣。

没有坐在 Crazy Cart Shift 的驾驶员座位上之前，切勿将 ON/OFF 开关设置为 **ON**（开）。坐好后再将电源开关设置为 **ON**，这样将避免站着进出 Crazy Cart Shift 时因踩油门踏板而造成身体失去平衡。从 Crazy Cart Shift 上下车之前，务必将 ON/OFF 开关设置为 **OFF**（关）。

**重要的控制功能：**油门踏板和方向盘 **Crazy Cart Shift** 可以实现真正令人激动的漂移、旋转和打转，这是普通的卡丁车无法实现的。如果您已经骑乘过 Razor RipStik® 或 Razor RipRider® 360，想想它们的脚轮以及它们如何快速实现方向的变换；或者想想 Razor Ground Force® Drifter™ 卡丁车是如何实现全速尾部漂移的。Crazy Cart Shift 配置了完全旋转前驱动轮和后脚轮，因此其在实现上述运动功能的基础上，还可实现更小半径的旋转。练习骑行 Crazy Cart Shift，随着不断的掌握，你会发现妙趣横生。但同所有其他运动产品一样，骑行时请务必谨慎，注意安全。

**油门踏板：**Crazy Cart Shift 有一个脚踏式油门，用于控制卡丁车的速度。通过该油门，可在 0-13 公里/小时的速度范围内驾驶该卡丁车。脚踩油门的力度决定着速度的大小。动态加速和减速功能是实现成功漂移的关键。所有的停止操作之前都应完全松开油门踏板。

**方向盘：**Crazy Cart Shift 的方向盘在很多方面不同于普通的汽车或卡丁车。关于 Crazy Cart Shift 的方向盘，需要记住的最重要的一点是：其上的箭头所指的方向是卡丁车即将行进的方向，与卡丁车其他部位的方位无关。如果需要卡丁车去哪里，只需将箭头指向该方位即可（在油门踏板上施加不同的力度可控制 Crazy Cart Shift 后部的运动，如下文所述）。

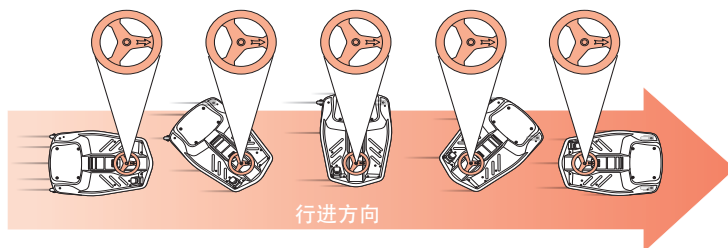

Crazy Cart Shift 的方向盘可在每个方向旋转 170° 以上。将方向盘转到其极限位置时，会产生“急停”——卡丁车将不会继续转动，但是通过将方向盘完全转到一个极限方向或完全转到另一个极限方向，可向后骑乘 Crazy Cart Shift；将方向盘转到 90° 或接近 90°，则 Crazy Cart Shift 可以非常小的圆漂移（注意，这可能存在引起眩晕的风险，请避免失控）。

Crazy Cart Shift 的转向装置集成了驱动和转向机构，大体类似于“碰碰车”的设计。其没有自动调整外倾角或后倾角的功能（也即转向管柱直线上升或直线下降，因此车轮不会自动“对齐”）。在某些情况下，这种转向可能会造成轻微的摆动或振动，这是正常现象。通常，这是由于不协调或不良的控制造成的。如果您在转向时觉得摆动，可改变方向（“反向转向”）和/或速度，这有助于重新建立平稳的控制。

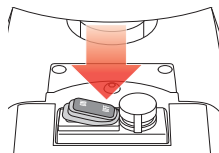

**重要说明：**请始终选择平坦、光滑、干燥和完全没有车辆或障碍物的场地进行骑乘。切勿在车辆周围骑乘！

**骑乘提示：**学习踩下和放开油门踏板的时机将提高您进行旋转、漂移和自如完成技巧的能力。学习 Crazy Cart Shift 功能的最好方法是在低速下尝试各种操作。

**警告：**长时间或超速旋转会导致失去平衡、失控和翻车。让身体的四肢和头部尽量处于 Crazy Cart Shift 的中心位置可降低翻车的风险，因为如果身体向外倾斜和/或旋转速度加速过快，则身体的惯性力会增加翻车的风险。如果旋转速度变得太快而无法控制，请将脚从油门踏板上抬起，不要试图通过加速退出旋转。骑乘者体重越轻，Crazy Cart Shift 加速越快，这也是将年龄限制在最小 8 岁的原因之一。请务必注意安全！



### 旋转、漂移和停止 Crazy Cart Shift

协调自如地操控方向盘和油门踏板才能得心应手地骑乘 Crazy Cart Shift。骑乘 Crazy Cart Shift 时，大部分的旋转和漂移操作需要熟练地控制油门和操控方向盘。学习在方向盘的哪个部位控制箭头方向并懂得何时增、减动力对于顺畅控制技巧性动作至关重要。顺畅地骑乘也会减少充电次数，从而增加骑乘时间。第一次骑乘 Crazy Cart Shift 时，强烈建议骑乘者慎重使用油门，并花一些时间熟悉组合反向转向和油门踏板控制操纵 Crazy Cart Shift 旋转和漂移的效果。

Crazy Cart Shift 没有单独的刹车，但通过练习，可轻松将其停下。当然，如果将脚从油门踏板上抬起，则由于驱动系统受到摩擦的原因，Crazy Cart Shift 会慢慢停下。要使 Crazy Cart Shift 向前的运动立即停止，请将脚从油门踏板上抬起并将方向盘转动 90° 到另一侧。将脚从油门踏板上抬起并转动方向盘会使 Crazy Cart Shift 以圆形旋转或漂移，从而慢慢停下。通过将方向盘转动 90° 并将脚从油门踏板上抬起，骑乘者可立即终止向前的运动而转向其他方向。这样，Crazy Cart Shift 可避免碰撞并可避开迎面而来的物体。

为了您的安全，请花一些时间熟悉并适应油门踏板、方向盘的各种组合应用，了解如何控制 Crazy Cart Shift 减速及停止。请练习这些技巧以尽量确保骑乘安全。

下面这些基本的转向练习可以帮助骑乘者熟悉 Crazy Cart Shift 的功能：

1. 首先转圈。
2. 转相同的圈，变化踩下油门踏板的力度，注意整个过程中速度提高和降低时 Crazy Cart Shift 的反应。您应该注意到，当转动导致 Crazy Cart Shift 卡滞时，加速会变得困难。
3. 继续转相同的圈，体验通过“反向转向”防止卡丁车卡滞的操作。反向转向消除 Crazy Cart Shift 卡滞的操作如下：将方向盘上的箭头指向与 Crazy Cart Shift 卡滞方向相反的方向。例如，如果向右转动困难，则表明卡丁车可能沿顺时针方向发生卡滞。可通过将方向盘稍微向左转动一下和/或减少施加在油门踏板上的力度来消除该卡滞。练习是掌握该技巧最好的方法。
4. 练习通过将脚从油门踏板上抬起并将方向盘向左或向右转动 90° 来停止 Crazy Cart Shift。
5. 练习进行小半径旋转或原地打转时蜷缩身体的控制动作。

**⚠ 警告：**请务必明确，这些专业的骑乘技巧会影响 Crazy Cart Shift 性能的发挥，同时请务必高度注意和慎重以确保骑乘条件和练习安全。请阅读并回顾“安全警告”，务必注意让 Crazy Cart Shift 远离车辆、障碍物和有下坡的环境。Crazy Cart Shift 不是“碰碰车”，其不适用于碰撞、跳跃活动，除坚硬、光滑、平坦且干燥的场地之外，不适用于其他场地。

## CUSTOMER SERVICE CONTACT INFORMATION

### AMERICAS

Razor USA LLC  
P.O. Box 3610  
Cerritos, CA 90703  
USA

+1 866 467 2967  
*Monday - Friday*  
*8:00 AM - 5:00 PM Pacific Time*  
customersupport@razorusa.com

### CHINA

Razor Trading (Shanghai) Co., Ltd  
Room 905, JZ Plaza, No. 2008  
Huqingping Road, Shanghai  
CHINA

+86 21 5976 8575

Printed in China for Razor USA LLC.

Copyright © 2003-2017 Razor USA, LLC. All rights reserved. Razor® and the Razor logo design are among the registered trademarks of Razor USA LLC in the United States and/or select foreign countries. Crazy Cart™ Shift™ is a trademark of Razor USA LLC.

## 售后服务中心联系信息

### 美国

美国锐哲有限公司  
邮政信箱 3610  
禧瑞都市 CA 90703  
美国

+1 866 467 2967  
星期一至星期五  
8:00 - 17:00 太平洋時間  
customersupport@razorusa.com

Razor USA LLC 中国专印

### 中国

锐哲贸易 (上海) 有限公司  
上海市沪青平公路2008号竞衡大业广场905室  
中国

+86 21 5976 8575

版权©2003-2017 年美国Razor有限公司版权所有。Razor® 以及Razor标志设计属于美国和/或其他所选国家内美国Razor有限公司的注册商标。 Crazy Cart™ Shift™是美国Razor有限公司的注册商标。

